

Kültür ve Turizm Bakanlıđından:

SIVAS KÜLTÜR VARLIKLARINI KORUMA BÖLGE KURULU KARAR

Toplantı Tarihi ve No : 29.03.2024-456
Karar Tarihi ve No : 29.03.2024-8587
Dosya No : 44.08.336

Toplantı Yeri
SIVAS

Malatya İli, Yeşilyurt İlçesi, Yakınca Mahallesi'nde sit dışında bulunan tapunun 1625 parselinde kayıtlı özel mülkiyete ait taşınmaz üzerinde yer alan konutun tescil talebini içeren 01.02.2024 tarih ve 2521067 sayılı şahıs başvurusu; Sivas Kültür Varlıklarını Koruma Bölge Kurulu Müdürlüğü'nün 27.02.2024 tarih ve 4817154 sayılı görüş yazısı, tescile esas ilgili ve etkilenen kurum ve kuruluşlarının görüşünü içeren Malatya Valiliđi Çevre, Şehircilik ve İklim Deđişikliği İl Müdürlüğü'nün 01.03.2024 tarih ve 8905576 sayılı yazısı, Yeşilyurt Kaymakamlığı, İlçe Yazı İşleri Müdürlüğü'nün 29.02.2024 tarih ve 13815 sayılı yazısı, Malatya Büyükşehir Belediye Başkanlığı İmar ve Şehircilik Daire Başkanlığı Kültür Varlıkları Şube Müdürlüğü'nün 19.03.2024 tarih ve 183456 sayılı yazısı ile Sivas Kültür Varlıklarını Koruma Bölge Kurulu Müdürlüğü uzmanlarının 22.03.2024 tarihli ve 2614447 sayılı inceleme raporu okundu, dosyasındaki bilgi ve belgeler incelendi.

Yapılan görüşme sonucunda, Malatya İli, Yeşilyurt İlçesi, Yakınca Mahallesi'nde sit dışında bulunan tapunun 1625 parselinde kayıtlı özel mülkiyete ait taşınmaz üzerinde yer alan konutun 2863 Sayılı Kanunun 6'ncı maddesi ile 13/03/2012 tarih ve 28232 sayılı Resmi Gazete'de yayımlanarak yürürlüğe giren Korunması Gerekli Taşınmaz Kültür Varlıklarının ve Sitlerin Tespit ve Tescili Hakkında Yönetmelik'in 4. maddesi kapsamında taşınmaz kültür varlığı özelliđi gösterdiğinden korunması gerekli taşınmaz kültür varlığı olarak tescil edilmesine; Kültür ve Tabiat Varlıklarını Koruma Yüksek Kurulu'nun 05.11.1999 tarih ve 660 sayılı ilke kararı doğrultusunda yapı grubunun 2'nci grup olarak belirlenmesine, Kurulumuzun 24.10.2019 tarih ve 5676 sayılı kararı ile belirlenen koruma alanının söz konusu taşınmaz için de geçerli olduğuna ve bu doğrultuda hazırlanan tescil fişinin uygun olduğuna,

İlgili tapu müdürlüğüne 2863 sayılı Yasanın 7'nci maddesi ile 13.03.2012 tarihli ve 28232 sayılı Resmi Gazete'de yayımlanarak yürürlüğe giren "*Korunması Gerekli Taşınmaz Kültür Varlıklarının ve Sitlerin Tespit ve Tescili Hakkındaki Yönetmelik*" gereğince tescil edilen taşınmazın tapu kütüğünün şerh ve beyanlar hanesine "**II. Grup Korunması Gerekli Taşınmaz Kültür Varlığıdır**" şeklinde kültür varlığı şerhi konularak sonucundan Kurul Müdürlüğüne bilgi verilmesine, tescilli taşınmaza yönelik her türlü fiziki ve inşaf (tevhid, ifraz, kazı, sondaj, onarım, vb.) müdahale öncesi Kurulumuzdan izin alınmasına

Korunması gerekli taşınmaz kültür varlığı olarak tescili yapılan yapıların yıkım tehlikesine karşı 2863 sayılı Kültür ve Tabiat Varlıklarını Koruma Kanunu'nun 10 uncu maddesi geređi ilgili İdarelerce can ve mal güvenliği açısından gerekli güvenlik tedbirlerinin alınmasına ve yapıların rölöve, restitüsyon ve restorasyon projelerinin ise Kültür ve Tabiat Varlıklarını Koruma Yüksek Kurulu'nun 05.11.1999 tarih ve 660 sayılı İlke Kararı kapsamında ilgililerce hazırlatılarak Kurulumuza iletilmesine, karar verildi.

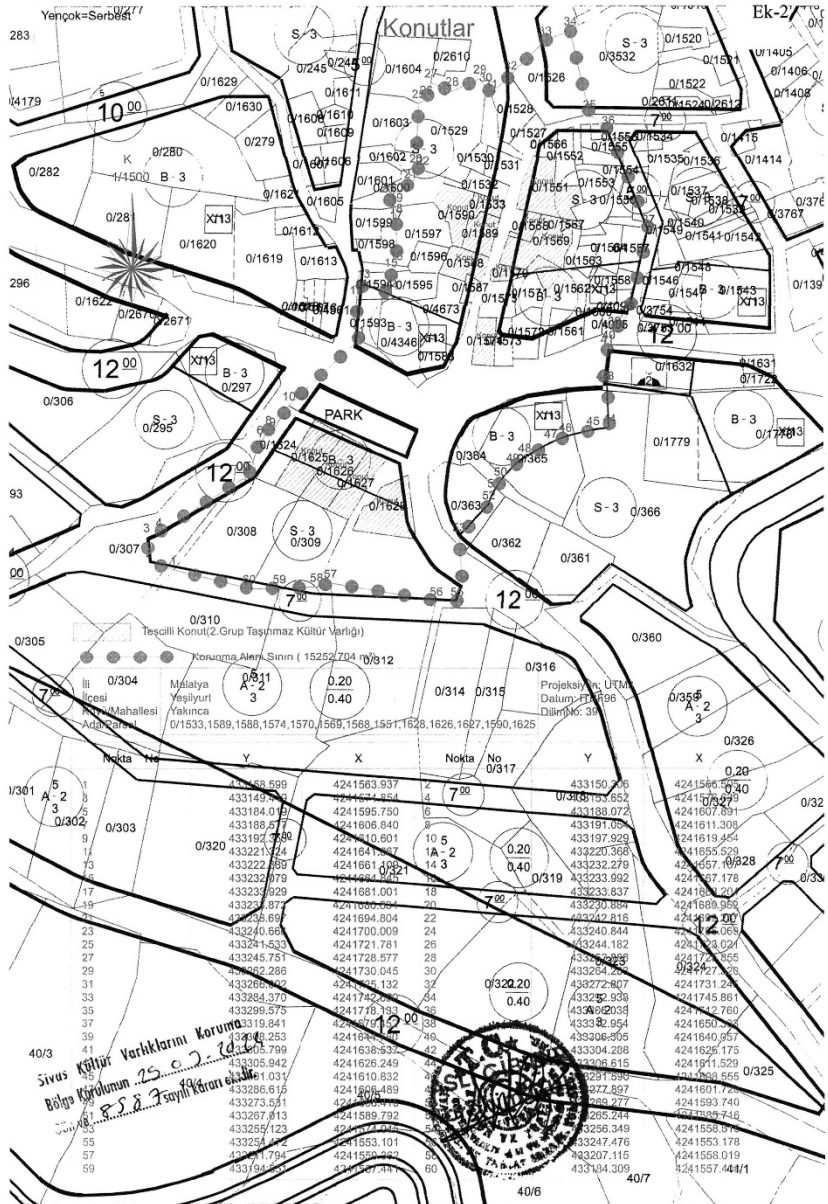

Tescilli Konut (2.Grup Tasınmaz Kültür Varlığı)
 Korunma Alanı Sınırı (15252/204 0/0/0/0)
 İlçe: Malatya
 İl: Kahramanmaraş
 Mahalle: Yakınca
 Köy: Adıyaman
 Proje Kayıt No: UTM
 Datum: F2796
 Dilim No: 39

| Nokta No | X | Y | Nokta No | X | Y |
|----------|-------------|-------------|----------|-------------|-------------|
| 1 | 4241563.937 | 4331507.716 | 1 | 4241563.937 | 4331507.716 |
| 2 | 4241564.854 | 4331703.652 | 2 | 4241564.854 | 4331703.652 |
| 3 | 4241595.750 | 433188.072 | 3 | 4241595.750 | 433188.072 |
| 4 | 4241606.840 | 433191.058 | 4 | 4241606.840 | 433191.058 |
| 5 | 4241610.601 | 433197.928 | 5 | 4241610.601 | 433197.928 |
| 6 | 4241641.567 | 433220.366 | 6 | 4241641.567 | 433220.366 |
| 7 | 4241661.081 | 433232.279 | 7 | 4241661.081 | 433232.279 |
| 8 | 4241672.205 | 433233.952 | 8 | 4241672.205 | 433233.952 |
| 9 | 4241681.001 | 433233.637 | 9 | 4241681.001 | 433233.637 |
| 10 | 4241694.804 | 433233.809 | 10 | 4241694.804 | 433233.809 |
| 11 | 4241730.045 | 433242.816 | 11 | 4241730.045 | 433242.816 |
| 12 | 4241700.009 | 433240.844 | 12 | 4241700.009 | 433240.844 |
| 13 | 4241721.781 | 433244.182 | 13 | 4241721.781 | 433244.182 |
| 14 | 4241728.577 | 433246.255 | 14 | 4241728.577 | 433246.255 |
| 15 | 4241730.045 | 433254.255 | 15 | 4241730.045 | 433254.255 |
| 16 | 4241736.132 | 433272.607 | 16 | 4241736.132 | 433272.607 |
| 17 | 4241742.262 | 433282.938 | 17 | 4241742.262 | 433282.938 |
| 18 | 4241718.133 | 433290.038 | 18 | 4241718.133 | 433290.038 |
| 19 | 4241672.205 | 433322.954 | 19 | 4241672.205 | 433322.954 |
| 20 | 4241681.001 | 433306.805 | 20 | 4241681.001 | 433306.805 |
| 21 | 4241638.533 | 433304.288 | 21 | 4241638.533 | 433304.288 |
| 22 | 4241626.249 | 433336.615 | 22 | 4241626.249 | 433336.615 |
| 23 | 4241610.832 | 433291.890 | 23 | 4241610.832 | 433291.890 |
| 24 | 4241601.189 | 433282.938 | 24 | 4241601.189 | 433282.938 |
| 25 | 4241627.551 | 433262.277 | 25 | 4241627.551 | 433262.277 |
| 26 | 4241589.792 | 433262.244 | 26 | 4241589.792 | 433262.244 |
| 27 | 4241571.075 | 433256.349 | 27 | 4241571.075 | 433256.349 |
| 28 | 4241553.101 | 433247.476 | 28 | 4241553.101 | 433247.476 |
| 29 | 4241550.362 | 433207.115 | 29 | 4241550.362 | 433207.115 |
| 30 | 4241567.371 | 433194.309 | 30 | 4241567.371 | 433194.309 |

Sivas Kültür Varlıklarını Koruma Bölge Kurulunun 25.02.2014 tarihli 8583 sayılı kararına istinaden



Kltr ve Turizm Bakanlıđından:

ADANA KLTR VARLIKLARINI KORUMA BLGE KURULU

KARAR

33.05.3810

TOPLANTI TARİHİ VE NO: 27.03.2024-572
KARAR TARİHİ VE NO : 27.03.2024-17526

TOPLANTI YERİ
ADANA

Mersin İli, Silifke İlçesi, Smek, Yeđenli, Seydili, Şahmurlu, Cambazlı Mahalleri sınırları ierisinde tespit edilen antik dnem su yolunun tescil edilmesine iliřkin; Mersin İI Kltr ve Turizm Mdrlđnn 11.12.2023 gn ve 4521584 sayılı yazısı, Koruma Blge Kurulu Mdrlđnn 13.01.2024 gn ve 4630906 sayılı yazısı, DSI 6. Blge Mdrlđnn bila gn ve 4257753 sayılı yazısı, Mersin Kadastro Mdrlđnn bila gn ve 11447981 sayılı yazısı, Silifke Belediyesi İmar ve Şehircilik Mdrlđnn 22.01.2024 gn ve 59640 sayılı yazısı, Maden ve Petrol İřleri Genel Mdrlđnn 19.01.2024 gn ve 2024034905 sayılı yazısı, Mersin evre ve Şehircilik İI Mdrlđnn 8572726 sayılı yazısı, Karayolları 5. Blge Mdrlđnn 25.01.2024 gn ve 1439095 sayılı yazısı, Silifke İle Tarım ve Orman Mdrlđnn 12987344 sayılı yazısı, Mersin İI Tarım ve Orman Mdrlđnn 13118483 sayılı yazısı, Mersin Bykřehir Belediye Bařkanlıđı İmar ve Şehircilik Dairesi Bařkanlıđının 06.02.2024 gn ve 731186 sayılı yazısı, Kurul Mdrlđ uzmanlarınca hazırlanan 25.03.2024 gn ve 2616818 sayılı yerinde inceleme raporu, ekleri ve konunun iřlem dosyası incelendi, yapılan grřmeler sonucunda;

Mersin İli, Silifke İlçesi, Smek, Yeđenli, Seydili, Şahmurlu, Cambazlı Mahalleri sınırları ierisinde tespit edilen antik dnem su yolunun 2863 sayılı yasanın 6. Maddesi kapsamında korunması gerekli tařınmaz kltr varlıđı niteliđi tařıdıđı Koruma Blge Kurulu Mdrlđ uzmanlarınca hazırlanan 25.03.2024 gn ve 2616818 sayılı rapordan anlařıldıđından, su yolunun tařınmaz kltr varlıđı olarak tescil edilmesine, koruma grubunun 1. Grup yapısı olarak belirlenmesine, kararımız eki anıt fiři ve koruma alanı haritasının uygun olduđuna karar verildi.

SU YOLU KORUNMA ALANI KOORDİNAT ÖZET ÇİZELGESİ

UTM 3 ITRF 96

UTM 6 ED 50

UTM 3 ITRF 96

UTM 6 ED 50

| Nokta No | (UTM)Universal Y | Trans ITRF96 X | (UTM)Universal Y2 | Trans ED50 X2 | (European Datum X2) |
|----------|---------------------|----------------------|----------------------|---------------------|---------------------------|
| 117 | 593096,906 | 4052346,148 | 593095,115 | 4050903,010 | |
| 118 | 593121,203 | 4052370,421 | 593119,403 | 4050923,876 | |
| 119 | 593153,104 | 4052396,190 | 593191,292 | 4050948,026 | |
| 120 | 593188,893 | 4052423,155 | 593167,078 | 4050956,993 | |
| 121 | 593188,236 | 4052420,937 | 593186,410 | 4050974,772 | |
| 122 | 593221,887 | 4052449,829 | 593220,018 | 4051003,453 | |
| 123 | 593235,461 | 4052467,328 | 593233,528 | 4051018,976 | |
| 124 | 593281,191 | 4052470,848 | 593278,328 | 4051024,664 | |
| 125 | 593296,916 | 4052476,496 | 593294,347 | 4051030,304 | |
| 126 | 593312,400 | 4052479,228 | 593310,526 | 4051033,040 | |
| 127 | 593315,239 | 4052481,131 | 593313,363 | 4051035,129 | |
| 128 | 593321,078 | 4052479,358 | 593318,860 | 4051033,770 | |
| 129 | 593340,548 | 4052485,885 | 593336,861 | 4051039,685 | |
| 130 | 593387,509 | 4052488,394 | 593365,612 | 4051042,203 | |
| 131 | 593444,272 | 4052494,071 | 593442,345 | 4051047,878 | |
| 132 | 593387,509 | 4052488,394 | 593365,612 | 4051042,203 | |
| 133 | 593534,252 | 4052500,066 | 593532,290 | 4051053,871 | |
| 134 | 593564,482 | 4052504,717 | 593562,507 | 4051064,519 | |
| 135 | 593587,238 | 4052517,247 | 593585,255 | 4051071,844 | |
| 136 | 593608,918 | 4052528,788 | 593606,628 | 4051082,581 | |
| 137 | 593626,769 | 4052536,862 | 593624,770 | 4051090,752 | |
| 138 | 593638,544 | 4052545,822 | 593636,541 | 4051099,608 | |
| 139 | 593646,713 | 4052551,902 | 593644,707 | 4051105,685 | |
| 140 | 593692,178 | 4052562,238 | 593690,170 | 4051106,022 | |
| 141 | 593670,871 | 4052545,051 | 593668,855 | 4051098,838 | |
| 142 | 593691,100 | 4052553,187 | 593688,976 | 4051106,970 | |
| 143 | 590002,439 | 4054673,313 | 590001,550 | 4053226,880 | |
| 144 | 590036,708 | 4054663,420 | 590035,805 | 4053216,373 | |
| 145 | 590008,513 | 4054640,536 | 590007,582 | 4053193,498 | |
| 146 | 590031,121 | 4054634,588 | 590030,181 | 4053187,586 | |
| 147 | 590038,596 | 4054622,990 | 590037,653 | 4053175,968 | |
| 148 | 590087,079 | 4054605,776 | 590085,129 | 4053148,756 | |
| 149 | 590074,489 | 4054587,876 | 590072,452 | 4053140,825 | |
| 150 | 590098,839 | 4054583,979 | 590096,923 | 4053136,964 | |
| 151 | 591033,925 | 4054571,701 | 591032,944 | 4053124,891 | |
| 152 | 591070,210 | 4054568,138 | 591069,214 | 4053111,313 | |
| 153 | 591097,894 | 4054545,008 | 591096,889 | 4053098,008 | |
| 154 | 591114,748 | 4054539,222 | 591114,736 | 4053092,224 | |
| 155 | 591135,590 | 4054527,992 | 591134,479 | 4053080,999 | |
| 156 | 591171,619 | 4054484,057 | 591170,585 | 4053037,081 | |
| 157 | 591201,277 | 4054460,649 | 591200,221 | 4053013,682 | |
| 158 | 591221,051 | 4054435,177 | 591219,987 | 4052988,222 | |
| 159 | 591228,589 | 4054422,896 | 591225,533 | 4052975,944 | |
| 160 | 591283,608 | 4054373,188 | 591282,537 | 4052928,256 | |
| 161 | 591316,470 | 4054343,360 | 591315,378 | 4052904,944 | |
| 162 | 591387,436 | 4054238,007 | 591386,325 | 4052770,128 | |
| 163 | 591396,846 | 4054196,430 | 591395,724 | 4052749,396 | |
| 164 | 591405,889 | 4054180,000 | 591404,972 | 4052738,112 | |
| 165 | 591467,475 | 4054168,664 | 591466,265 | 4052673,445 | |
| 166 | 591501,787 | 4054150,570 | 591500,563 | 4052604,768 | |
| 167 | 591557,314 | 4054135,307 | 591556,145 | 4052557,539 | |
| 168 | 591583,274 | 4054124,814 | 591582,063 | 4052478,888 | |
| 169 | 591592,258 | 4054091,655 | 591591,059 | 4052469,762 | |
| 170 | 591636,329 | 4054079,060 | 591634,114 | 4052442,892 | |
| 171 | 591676,590 | 4054064,433 | 591675,274 | 4052393,716 | |
| 172 | 591722,550 | 4054050,222 | 591721,299 | 4052361,512 | |
| 173 | 591759,690 | 4054037,500 | 591758,600 | 4052338,500 | |
| 174 | 591780,155 | 4053777,240 | 591778,881 | 4052332,541 | |

| Nokta No | (UTM)Universal Y | Trans ITRF96 X | (UTM)Universal Y2 | Trans ED50 X2 | (European Datum X2) |
|----------|---------------------|----------------------|----------------------|---------------------|---------------------------|
| 175 | 591819,349 | 4053746,676 | 591818,060 | 4052299,390 | |
| 176 | 591859,768 | 4053678,631 | 591858,461 | 4052321,972 | |
| 177 | 591942,216 | 4053544,495 | 591940,879 | 4052097,889 | |
| 178 | 591977,433 | 4053463,761 | 591976,186 | 4052051,186 | |
| 179 | 591994,317 | 4053434,483 | 591992,959 | 4051987,919 | |
| 180 | 592027,946 | 4053393,995 | 592026,576 | 4051947,448 | |
| 181 | 592037,071 | 4053378,325 | 592036,987 | 4051933,385 | |
| 182 | 592074,454 | 4053338,332 | 592072,066 | 4051891,807 | |
| 183 | 592101,146 | 4053311,798 | 592099,747 | 4051865,243 | |
| 184 | 592138,407 | 4053286,862 | 592136,399 | 4051802,071 | |
| 185 | 592154,131 | 4053252,302 | 592152,711 | 4051762,819 | |
| 186 | 592173,394 | 4053217,127 | 592171,987 | 4051770,549 | |
| 187 | 592194,195 | 4053206,889 | 592192,724 | 4051760,215 | |
| 188 | 592202,861 | 4053202,061 | 592201,422 | 4051735,803 | |
| 189 | 592239,414 | 4053122,177 | 592237,961 | 4051679,736 | |
| 190 | 592278,797 | 4053091,096 | 592276,336 | 4051644,067 | |
| 191 | 592261,877 | 4053087,140 | 592260,956 | 4051640,722 | |
| 192 | 592303,806 | 4053046,242 | 592302,329 | 4051599,832 | |
| 193 | 592328,653 | 4053020,861 | 592327,164 | 4051574,460 | |
| 194 | 592357,757 | 4052993,123 | 592356,257 | 4051546,733 | |
| 195 | 592365,541 | 4052986,012 | 592364,028 | 4051538,225 | |
| 196 | 592378,610 | 4052966,805 | 592377,162 | 4051520,525 | |
| 197 | 592393,536 | 4052931,554 | 592392,021 | 4051485,188 | |
| 198 | 592431,025 | 4052872,708 | 592429,996 | 4051426,385 | |
| 199 | 592447,680 | 4052843,993 | 592446,144 | 4051397,572 | |
| 200 | 592468,869 | 4052806,650 | 592467,325 | 4051360,334 | |
| 201 | 592483,329 | 4052784,197 | 592481,779 | 4051347,885 | |
| 202 | 592522,316 | 4052732,884 | 592521,158 | 4051311,582 | |
| 203 | 592545,380 | 4052727,580 | 592543,411 | 4051286,092 | |
| 204 | 592599,892 | 4052710,345 | 592597,997 | 4051264,066 | |
| 205 | 592612,352 | 4052691,792 | 592611,253 | 4051249,978 | |
| 206 | 592624,062 | 4052676,021 | 592622,477 | 4051240,102 | |
| 207 | 592639,652 | 4052655,917 | 592638,041 | 4051219,656 | |
| 208 | 592664,651 | 4052631,440 | 592662,323 | 4051188,214 | |
| 209 | 592683,645 | 4052595,450 | 592682,652 | 4051148,217 | |
| 210 | 592703,465 | 4052569,284 | 592701,829 | 4051138,069 | |
| 211 | 592735,294 | 4052548,388 | 592733,498 | 4051126,243 | |
| 212 | 592746,665 | 4052531,743 | 592744,829 | 4051125,518 | |
| 213 | 592760,545 | 4052519,297 | 592759,641 | 4051128,274 | |
| 214 | 592778,091 | 4052507,917 | 592776,917 | 4051124,407 | |
| 215 | 592807,706 | 4052486,542 | 592805,590 | 4051120,320 | |
| 216 | 592828,222 | 4052469,297 | 592826,873 | 4051118,615 | |
| 217 | 592836,562 | 4052459,843 | 592834,563 | 4051113,820 | |
| 218 | 592842,525 | 4052454,317 | 592840,573 | 4051108,100 | |
| 219 | 592847,522 | 4052448,283 | 592844,530 | 4051106,066 | |
| 220 | 592848,120 | 4052444,129 | 592846,092 | 4051104,992 | |
| 221 | 592849,745 | 4052440,525 | 592847,729 | 4051100,515 | |
| 222 | 592849,745 | 4052440,525 | 592847,729 | 4051100,515 | |
| 223 | 592849,745 | 4052440,525 | 592847,729 | 4051100,515 | |
| 224 | 592849,745 | 4052440,525 | 592847,729 | 4051100,515 | |
| 225 | 592849,745 | 4052440,525 | 592847,729 | 4051100,515 | |
| 226 | 592849,745 | 4052440,525 | 592847,729 | 4051100,515 | |
| 227 | 592849,745 | 4052440,525 | 592847,729 | 4051100,515 | |
| 228 | 592849,745 | 4052440,525 | 592847,729 | 4051100,515 | |
| 229 | 592849,745 | 4052440,525 | 592847,729 | 4051100,515 | |
| 230 | 592849,745 | 4052440,525 | 592847,729 | 4051100,515 | |
| 231 | 592849,745 | 4052440,525 | 592847,729 | 4051100,515 | |
| 232 | 592849,745 | 4052440,525 | 592847,729 | 4051100,515 | |

Adana Kültür Varlıkları

Koruma Bölge Kurulunun

27.03.2014 gününe kadar

Karar Ekidir

SU YOLU KORUNMA ALANI KOORDİNAT ÖZET ÇİZELGESİ

UTM 3 ITRF 96

UTM 6 ED 50

UTM 3 ITRF 96

UTM 6 ED 50

| Nokta No | (UTM)Universal Y | Trans ITRF96 X | (International X | (UTM)Universal Y2 | Trans ED50 X2 | (European Datum X2 |
|----------|---------------------|-------------------|---------------------|----------------------|------------------|--------------------------|
| 233 | 593200.683 | 4052500.609 | | 592318.805 | 4051054.413 | |
| 234 | 593304.321 | 4052488.115 | | 593302.449 | 4051553.108 | |
| 235 | 593291.451 | 4052489.889 | | 593289.784 | 4051049.695 | |
| 236 | 593274.420 | 4052489.868 | | 593273.059 | 4051043.056 | |
| 237 | 592791.841 | 4052480.184 | | 592790.170 | 4051034.006 | |
| 238 | 593227.889 | 4052476.899 | | 593226.647 | 4051029.512 | |
| 239 | 592734.982 | 4052476.899 | | 592732.917 | 4051025.147 | |
| 240 | 593210.415 | 4052466.157 | | 593208.579 | 4051019.974 | |
| 241 | 592799.430 | 4052447.896 | | 592797.757 | 4051001.720 | |
| 242 | 593174.972 | 4052435.910 | | 593173.151 | 4050997.740 | |
| 243 | 592815.294 | 4052427.632 | | 592813.614 | 4050981.464 | |
| 244 | 592819.646 | 4052421.840 | | 592817.968 | 4050975.675 | |
| 245 | 593187.034 | 4052415.419 | | 593185.219 | 4050971.254 | |
| 246 | 593142.078 | 4052410.918 | | 593140.270 | 4050964.729 | |
| 247 | 592858.006 | 4052394.357 | | 592856.300 | 4050944.712 | |
| 248 | 593108.438 | 4052385.592 | | 593106.822 | 4050939.441 | |
| 249 | 592864.832 | 4052379.112 | | 592863.133 | 4050932.963 | |
| 250 | 592862.186 | 4052366.460 | | 592860.488 | 4050920.338 | |
| 251 | 593084.963 | 4052364.899 | | 593082.877 | 4050918.492 | |
| 252 | 592882.079 | 4052359.346 | | 592880.373 | 4050913.205 | |
| 253 | 592877.091 | 4052358.354 | | 592876.347 | 4050912.214 | |
| 254 | 592856.123 | 4052355.008 | | 592853.412 | 4050911.487 | |
| 255 | 592867.277 | 4052346.842 | | 592865.676 | 4050910.803 | |
| 256 | 592856.251 | 4052345.527 | | 592856.554 | 4050909.387 | |
| 257 | 592858.271 | 4052335.491 | | 592856.874 | 4050909.391 | |
| 258 | 593061.782 | 4052348.149 | | 593060.005 | 4050903.012 | |
| 259 | 592904.483 | 4052340.642 | | 592902.748 | 4050884.808 | |
| 260 | 592907.666 | 4052334.217 | | 592905.950 | 4050888.087 | |
| 261 | 593042.391 | 4052326.756 | | 593040.622 | 4050883.627 | |
| 262 | 592911.827 | 4052321.695 | | 592910.110 | 4050880.967 | |
| 263 | 592914.675 | 4052320.644 | | 592912.956 | 4050873.919 | |
| 264 | 593033.176 | 4052312.204 | | 593031.411 | 4050866.082 | |
| 265 | 592915.058 | 4052307.439 | | 592913.339 | 4050861.918 | |
| 266 | 593026.792 | 4052302.478 | | 593025.029 | 4050856.360 | |
| 267 | 592913.396 | 4052300.914 | | 592911.677 | 4050854.797 | |
| 268 | 593023.807 | 4052286.952 | | 593020.282 | 4050846.882 | |
| 269 | 592905.641 | 4052281.407 | | 592903.526 | 4050843.296 | |
| 270 | 593002.874 | 4052281.391 | | 593001.121 | 4050835.280 | |
| 271 | 592905.789 | 4052274.328 | | 592904.029 | 4050828.917 | |
| 272 | 592910.217 | 4052267.876 | | 592908.500 | 4050824.771 | |
| 273 | 592980.878 | 4052265.882 | | 592979.130 | 4050819.878 | |
| 274 | 592922.719 | 4052257.013 | | 592901.308 | 4050815.819 | |
| 275 | 592955.614 | 4052251.334 | | 592953.979 | 4050814.336 | |
| 276 | 592987.638 | 4052249.488 | | 592986.126 | 4050809.890 | |
| 277 | 592984.254 | 4052243.706 | | 592981.543 | 4050807.983 | |
| 278 | 592936.928 | 4052241.666 | | 592935.200 | 4050795.571 | |
| 279 | 592922.985 | 4052232.816 | | 592921.263 | 4050786.723 | |
| 280 | 592989.263 | 4052223.857 | | 592987.857 | 4050782.857 | |
| 281 | 592988.131 | 4052227.272 | | 592987.422 | 4050781.183 | |
| 282 | 592908.492 | 4052224.246 | | 592907.775 | 4050776.258 | |
| 283 | 592938.293 | 4052223.346 | | 592935.888 | 4050772.918 | |
| 284 | 592903.007 | 4052222.430 | | 592901.233 | 4050776.343 | |
| 285 | 592903.586 | 4052222.241 | | 592899.350 | 4050776.154 | |
| 286 | 593507.465 | 4051588.588 | | 593501.423 | 4051583.288 | |
| 287 | 593537.375 | 4051588.588 | | 593534.626 | 4051583.288 | |
| 288 | 593547.544 | 4051588.588 | | 593544.798 | 4051583.288 | |
| 289 | 593582.230 | 4051588.588 | | 593579.463 | 4051583.288 | |
| 290 | 593625.649 | 4051588.588 | | 593622.865 | 4051583.288 | |

| Nokta No | (UTM)Universal Y | Trans ITRF96 X | (International X | (UTM)Universal Y2 | Trans ED50 X2 | (European Datum X2 |
|----------|---------------------|-------------------|---------------------|----------------------|------------------|--------------------------|
| 291 | 595688.361 | 4051556.368 | | 595685.553 | 4050110.544 | |
| 292 | 595717.789 | 4051553.108 | | 595714.960 | 4050107.285 | |
| 293 | 595745.874 | 4051551.891 | | 595743.142 | 4050105.839 | |
| 294 | 595795.866 | 4051549.807 | | 595795.987 | 4050106.907 | |
| 295 | 595788.651 | 4051540.218 | | 595795.799 | 4050109.400 | |
| 296 | 595819.125 | 4051534.748 | | 595816.265 | 4050108.932 | |
| 297 | 595812.913 | 4051533.378 | | 595812.913 | 4050104.548 | |
| 298 | 595854.306 | 4051536.308 | | 595851.432 | 4050109.491 | |
| 299 | 595859.157 | 4051543.144 | | 595856.282 | 4050107.234 | |
| 300 | 595874.878 | 4051550.336 | | 595874.797 | 4050104.544 | |
| 301 | 595888.012 | 4051557.179 | | 595883.121 | 4050111.354 | |
| 302 | 595911.959 | 4051556.903 | | 595909.054 | 4050111.139 | |
| 303 | 595931.381 | 4051566.408 | | 595928.477 | 4050117.573 | |
| 304 | 595946.727 | 4051567.298 | | 595943.856 | 4050121.460 | |
| 305 | 595944.011 | 4051572.167 | | 595961.094 | 4050126.356 | |
| 306 | 595976.460 | 4051576.762 | | 595973.538 | 4050130.300 | |
| 307 | 595994.705 | 4051576.963 | | 595994.776 | 4050131.131 | |
| 308 | 596000.379 | 4051571.376 | | 595997.448 | 4050125.545 | |
| 309 | 596005.130 | 4051570.622 | | 596002.197 | 4050124.792 | |
| 310 | 596012.393 | 4051571.763 | | 596009.458 | 4050125.832 | |
| 311 | 596009.692 | 4051568.282 | | 596006.379 | 4050122.646 | |
| 312 | 596017.050 | 4051566.807 | | 596014.089 | 4050122.453 | |
| 313 | 596091.083 | 4051567.238 | | 596088.091 | 4050121.409 | |
| 314 | 596098.846 | 4051566.141 | | 596095.876 | 4050120.312 | |
| 315 | 596101.633 | 4051566.807 | | 596104.089 | 4050120.978 | |
| 316 | 596106.333 | 4051573.445 | | 596103.960 | 4050128.114 | |
| 317 | 596111.647 | 4051579.971 | | 596108.672 | 4050134.137 | |
| 318 | 596122.993 | 4051581.233 | | 596120.002 | 4050131.684 | |
| 319 | 596166.442 | 4051602.729 | | 596163.445 | 4050156.887 | |
| 320 | 595505.296 | 4051568.758 | | 595502.859 | 4050122.928 | |
| 321 | 595511.634 | 4051568.758 | | 595508.887 | 4050148.481 | |
| 322 | 596128.352 | 4051566.309 | | 596123.371 | 4050120.481 | |
| 323 | 596122.965 | 4051561.800 | | 596119.985 | 4050116.153 | |
| 324 | 595540.217 | 4051561.566 | | 595540.217 | 4050116.153 | |
| 325 | 595886.601 | 4051558.873 | | 595883.676 | 4050111.048 | |
| 326 | 595980.126 | 4051556.802 | | 595977.202 | 4050110.977 | |
| 327 | 595978.187 | 4051552.278 | | 595975.152 | 4050107.329 | |
| 328 | 595993.915 | 4051552.625 | | 595989.887 | 4050106.802 | |
| 329 | 595971.890 | 4051551.890 | | 595974.922 | 4050106.168 | |
| 330 | 596013.224 | 4051551.890 | | 596010.287 | 4050105.825 | |
| 331 | 596005.177 | 4051550.275 | | 596002.184 | 4050104.563 | |
| 332 | 596013.224 | 4051548.344 | | 596010.714 | 4050103.122 | |
| 333 | 596013.224 | 4051548.344 | | 596010.714 | 4050103.122 | |
| 334 | 596076.299 | 4051548.289 | | 596073.338 | 4050102.461 | |
| 335 | 596013.224 | 4051548.344 | | 596010.714 | 4050103.122 | |
| 336 | 596013.224 | 4051548.344 | | 596010.714 | 4050103.122 | |
| 337 | 596013.224 | 4051548.344 | | 596010.714 | 4050103.122 | |
| 338 | 596013.224 | 4051548.344 | | 596010.714 | 4050103.122 | |
| 339 | 596013.224 | 4051548.344 | | 596010.714 | 4050103.122 | |
| 340 | 596013.224 | 4051548.344 | | 596010.714 | 4050103.122 | |
| 341 | 596013.224 | 4051548.344 | | 596010.714 | 4050103.122 | |
| 342 | 596013.224 | 4051548.344 | | 596010.714 | 4050103.122 | |
| 343 | 596013.224 | 4051548.344 | | 596010.714 | 4050103.122 | |
| 344 | 596013.224 | 4051548.344 | | 596010.714 | 4050103.122 | |
| 345 | 596013.224 | 4051548.344 | | 596010.714 | 4050103.122 | |
| 346 | 596013.224 | 4051548.344 | | 596010.714 | 4050103.122 | |
| 347 | 596013.224 | 4051548.344 | | 596010.714 | 4050103.122 | |
| 348 | 596013.224 | 4051548.344 | | 596010.714 | 4050103.122 | |

Adana Kültür Varlıklarını
Koruma Bölge Kurulunun
22.08.2022 gün. 13.38 sayılı
Karar Ekiidir

Adana Kültür Varlıklarını
Koruma Bölge Kurulu Onayı
Başkan
Becken Y
R

SU YOLU KORUNMA ALANI KOORDİNAT ÖZET ÇİZELGESİ

UTM 3 ITRF 96

UTM 6 ED 50

| Nokta No | (UTM)Universal Y | Trans Z | (ITRF96 X | (UTM)Universal Y2 | Trans ED50 (European Datum X2 |
|----------|---------------------|------------|--------------|----------------------|-------------------------------------|
| 348 | 595867.448 | | 4051520.259 | 595864.569 | 4050074.459 |
| 350 | 595813.732 | | 4051515.487 | 595810.874 | 4050069.979 |
| 351 | 595839.673 | | 4051507.589 | 595836.805 | 4050062.083 |
| 352 | 594396.938 | | 4051747.222 | 594394.640 | 4050301.322 |
| 353 | 594446.615 | | 4051725.284 | 594444.295 | 4050283.391 |
| 354 | 594471.132 | | 4051723.565 | 594468.802 | 4050277.674 |
| 355 | 594506.177 | | 4051720.462 | 594503.832 | 4050274.572 |
| 356 | 594531.710 | | 4051716.133 | 594529.355 | 4050270.246 |
| 357 | 594568.736 | | 4051721.742 | 594565.368 | 4050275.852 |
| 358 | 594593.878 | | 4051729.736 | 594591.499 | 4050283.343 |
| 359 | 594640.085 | | 4051742.512 | 594637.688 | 4050296.614 |
| 360 | 594685.112 | | 4051754.332 | 594682.696 | 4050309.029 |
| 361 | 594734.670 | | 4051764.049 | 594732.236 | 4050318.142 |
| 362 | 594738.289 | | 4051744.379 | 594735.853 | 4050298.480 |
| 363 | 594689.589 | | 4051735.420 | 594687.173 | 4050289.525 |
| 364 | 594391.180 | | 4051728.069 | 594376.895 | 4050282.777 |
| 365 | 594645.412 | | 4051723.234 | 594643.013 | 4050277.344 |
| 366 | 594599.575 | | 4051710.561 | 594597.194 | 4050264.675 |
| 367 | 594441.460 | | 4051709.350 | 594439.141 | 4050264.965 |
| 368 | 594467.962 | | 4051703.767 | 594465.633 | 4050257.884 |
| 369 | 594573.292 | | 4051702.204 | 594570.922 | 4050256.322 |
| 370 | 594503.619 | | 4051700.610 | 594501.276 | 4050254.728 |
| 371 | 594331.531 | | 4051695.878 | 594429.177 | 4050243.998 |
| 372 | 590788.802 | | 4054667.208 | 590787.917 | 4053210.163 |
| 373 | 590796.036 | | 4054675.482 | 590795.149 | 4053228.430 |
| 374 | 593698.223 | | 4052575.412 | 593686.200 | 4051127.188 |
| 375 | 593695.334 | | 4052554.350 | 593693.308 | 4051108.133 |
| 376 | 594740.108 | | 4051754.684 | 594737.672 | 4050318.777 |
| 377 | 594591.025 | | 4051745.833 | 594379.531 | 4050302.932 |
| 378 | 594743.913 | | 4051745.662 | 594741.476 | 4050293.763 |
| 379 | 594375.570 | | 4051729.755 | 594373.277 | 4050283.862 |
| 380 | 596155.938 | | 4051620.198 | 596152.945 | 4050174.349 |
| 381 | 596170.305 | | 4051606.601 | 596167.307 | 4050158.967 |
| 382 | 595502.846 | | 4051569.090 | 595500.111 | 4050143.253 |
| 383 | 595600.659 | | 4051568.758 | 595497.324 | 4050122.928 |

ADANA KÜLTÜR VARLIKLARINI KORUMA BÖLGE

KURULUNUN 27.03.2024 GÜN VE 17526

SAYILI KARAR EKİDİR.

ADANA KÜLTÜR VARLIKLARINI KORUMA
BÖLGE KURULU ONAYI

BAŞKAN

BAŞKAN YRD.

ÜYE

ÜYE

ÜYE

ÜYE

ÜYE

ÜYE

ÜYE

ÜYE

ÜYE

ÜYE

ÜYE

ÜYE

ÜYE

ÜYE

ÜYE

ÜYE

ÜYE

ÜYE

ÜYE

ÜYE

ÜYE

ÜYE

ÜYE

ÜYE

ÜYE

ÜYE

ÜYE

ÜYE

ÜYE

ÜYE

ÜYE

SU YOLU KOORDİNAT ÖZET ÇİZELGESİ

Oye
Oya
Oye
Ore

5
15

UTM 3 ITRF 96

UTM 6 ED 50

UTM 3 ITRF 96

UTM 6 ED 50

| Nokta No | (UTM)Universal Y | Trans X | ITRF96 (Internationa X | (UTM)Universal Y2 | Trans X2 | ED50 (European Datum X2 |
|----------|---------------------|------------|---------------------------|----------------------|-------------|----------------------------|
| 1 | 590799.507 | | 4054664.370 | 590798.618 | 4053217.323 | |
| 2 | 590833.724 | | 4054683.875 | 590832.822 | 4053204.833 | |
| 3 | 590859.720 | | 4054630.330 | 590859.730 | 4053209.743 | |
| 4 | 590824.822 | | 4054625.902 | 590823.885 | 4053178.871 | |
| 5 | 590503.257 | | 4054617.479 | 590929.317 | 4053170.451 | |
| 6 | 590550.380 | | 4054587.439 | 590548.437 | 4053140.822 | |
| 7 | 590974.432 | | 4054678.242 | 590970.477 | 4053131.229 | |
| 8 | 590994.448 | | 4054574.253 | 590993.484 | 4053127.241 | |
| 9 | 591030.599 | | 4054582.399 | 591029.628 | 4053115.262 | |
| 10 | 591066.309 | | 4054548.922 | 591065.316 | 4053104.920 | |
| 11 | 591094.116 | | 4054535.733 | 591093.112 | 4053088.736 | |
| 12 | 591110.716 | | 4054530.033 | 591109.707 | 4053083.038 | |
| 13 | 591120.018 | | 4054520.120 | 591121.348 | 4053073.139 | |
| 14 | 591164.579 | | 4054476.875 | 591163.547 | 4053029.901 | |
| 16 | 591194.122 | | 4054453.598 | 591193.679 | 4053006.592 | |
| 17 | 591212.388 | | 4054429.873 | 591211.348 | 4052983.024 | |
| 18 | 591217.925 | | 4054417.875 | 591216.873 | 4052970.836 | |
| 19 | 591258.644 | | 4054367.139 | 591244.577 | 4052926.209 | |
| 20 | 591308.495 | | 4054298.006 | 591307.407 | 4052892.063 | |
| 21 | 591359.403 | | 4054230.051 | 591358.295 | 4052783.174 | |
| 22 | 591388.867 | | 4054190.431 | 591387.747 | 4052743.571 | |
| 23 | 591387.414 | | 4054179.222 | 591386.291 | 4052732.458 | |
| 24 | 591439.576 | | 4054078.907 | 591458.069 | 4052683.090 | |
| 25 | 591459.261 | | 4054025.733 | 591457.415 | 4052668.993 | |
| 26 | 591549.265 | | 4053948.363 | 591548.878 | 4052601.593 | |
| 27 | 591576.284 | | 4053916.427 | 591575.071 | 4052469.675 | |
| 28 | 591685.856 | | 4053898.630 | 591684.659 | 4052442.080 | |
| 29 | 591728.628 | | 4053871.447 | 591727.411 | 4052424.712 | |
| 30 | 591670.200 | | 4053832.649 | 591668.370 | 4052385.529 | |
| 31 | 591717.414 | | 4053799.611 | 591716.165 | 4052352.904 | |
| 32 | 591728.152 | | 4053770.874 | 591728.358 | 4052333.973 | |
| 33 | 591774.634 | | 4053770.826 | 591773.363 | 4052324.130 | |
| 34 | 591811.732 | | 4053740.087 | 591810.246 | 4052298.403 | |
| 35 | 591851.207 | | 4053691.009 | 591848.606 | 4052228.822 | |
| 36 | 591933.330 | | 4053539.855 | 591931.596 | 4052093.250 | |
| 37 | 591968.491 | | 4053459.250 | 591967.144 | 4052012.677 | |
| 38 | 591986.082 | | 4053404.263 | 591984.825 | 4051982.188 | |
| 39 | 592019.877 | | 4053388.060 | 592018.509 | 4051941.514 | |
| 40 | 592029.108 | | 4053373.825 | 592027.737 | 4051927.295 | |
| 41 | 592057.205 | | 4053357.441 | 592046.854 | 4051894.973 | |
| 42 | 592093.183 | | 4053305.575 | 592091.787 | 4051859.062 | |
| 43 | 592130.179 | | 4053242.827 | 592128.799 | 4051796.339 | |
| 44 | 592147.411 | | 4053225.787 | 592145.823 | 4051771.003 | |
| 45 | 592167.176 | | 4053209.228 | 592165.791 | 4051762.753 | |
| 46 | 592176.671 | | 4053190.018 | 592175.242 | 4051753.546 | |
| 47 | 592154.592 | | 4053176.597 | 592153.163 | 4051732.823 | |
| 48 | 592230.837 | | 4053117.036 | 592229.387 | 4051670.597 | |
| 49 | 592249.857 | | 4053084.877 | 592248.399 | 4051638.451 | |
| 50 | 592254.929 | | 4053079.989 | 592253.166 | 4051633.678 | |
| 51 | 592296.745 | | 4053039.162 | 592295.269 | 4051592.754 | |
| 52 | 592321.628 | | 4053084.877 | 592320.142 | 4051567.343 | |
| 53 | 592350.935 | | 4052985.811 | 592349.437 | 4051532.643 | |
| 54 | 592357.941 | | 4052979.410 | 592356.441 | 4051533.026 | |
| 55 | 592369.789 | | 4052968.289 | 592368.284 | 4051516.711 | |
| 56 | 592368.862 | | 4052968.289 | 592368.284 | 4051516.711 | |
| 57 | 592422.955 | | 4052867.545 | 592421.429 | 4051421.205 | |
| 58 | 592438.973 | | 4052838.985 | 592437.441 | 4051392.856 | |
| 59 | 592461.032 | | 4052800.202 | 592459.492 | 4051353.888 | |

| Nokta No | (UTM)Universal Y | Trans X | ITRF96 (Internationa X | (UTM)Universal Y2 | Trans X2 | ED50 (European Datum X2 |
|----------|---------------------|------------|---------------------------|----------------------|-------------|----------------------------|
| 59 | 592476.655 | | 4052786.655 | 592475.109 | 4051340.438 | |
| 60 | 592516.677 | | 4052749.844 | 592514.714 | 4051303.550 | |
| 61 | 592573.869 | | 4052700.743 | 592558.163 | 4051277.595 | |
| 62 | 592594.001 | | 4052694.001 | 592594.001 | 4051255.775 | |
| 63 | 592605.304 | | 4052693.304 | 592603.786 | 4051247.867 | |
| 64 | 592616.176 | | 4052688.247 | 592614.574 | 4051233.990 | |
| 65 | 592631.622 | | 4052659.362 | 592630.917 | 4051213.603 | |
| 66 | 592656.530 | | 4052626.524 | 592654.913 | 4051179.379 | |
| 67 | 592682.517 | | 4052589.116 | 592680.890 | 4051142.885 | |
| 68 | 592696.504 | | 4052574.098 | 592696.871 | 4051127.873 | |
| 69 | 592709.688 | | 4052562.622 | 592708.050 | 4051116.401 | |
| 70 | 592723.403 | | 4052551.648 | 592721.760 | 4051105.431 | |
| 71 | 592732.101 | | 4052545.913 | 592736.454 | 4051099.699 | |
| 72 | 592740.151 | | 4052540.534 | 592738.501 | 4051094.622 | |
| 73 | 592748.879 | | 4052534.852 | 592747.225 | 4051088.342 | |
| 74 | 592758.932 | | 4052528.173 | 592757.274 | 4051081.866 | |
| 75 | 592772.855 | | 4052508.562 | 592771.132 | 4051060.363 | |
| 76 | 592782.305 | | 4052477.183 | 592780.936 | 4051030.396 | |
| 77 | 592784.892 | | 4052468.834 | 592783.225 | 4051022.650 | |
| 78 | 592790.114 | | 4052443.577 | 592788.441 | 4050997.403 | |
| 79 | 592807.359 | | 4052421.546 | 592806.682 | 4050975.380 | |
| 80 | 592812.404 | | 4052414.565 | 592816.526 | 4050968.403 | |
| 81 | 592849.546 | | 4052388.366 | 592848.259 | 4050942.214 | |
| 82 | 592854.394 | | 4052378.009 | 592852.693 | 4050931.911 | |
| 83 | 592852.541 | | 4052369.208 | 592856.846 | 4050926.828 | |
| 84 | 592847.297 | | 4052354.613 | 592845.604 | 4050908.474 | |
| 85 | 592852.968 | | 4052344.506 | 592851.273 | 4050898.371 | |
| 86 | 592862.787 | | 4052347.087 | 592861.087 | 4050890.920 | |
| 87 | 592878.734 | | 4052348.494 | 592877.929 | 4050902.357 | |
| 88 | 592882.546 | | 4052346.245 | 592880.840 | 4050903.108 | |
| 89 | 592883.828 | | 4052348.891 | 592883.828 | 4050903.108 | |
| 90 | 592895.582 | | 4052336.041 | 592892.871 | 4050899.910 | |
| 91 | 592898.813 | | 4052328.564 | 592897.100 | 4050883.436 | |
| 92 | 592902.296 | | 4052322.296 | 592902.296 | 4050876.170 | |
| 93 | 592904.737 | | 4052317.848 | 592903.023 | 4050871.724 | |
| 94 | 592905.020 | | 4052306.543 | 592903.305 | 4050862.422 | |
| 95 | 592904.118 | | 4052295.002 | 592904.118 | 4050858.893 | |
| 96 | 592892.614 | | 4052287.534 | 592890.950 | 4050841.421 | |
| 97 | 592896.221 | | 4052278.047 | 592894.509 | 4050831.938 | |
| 98 | 592891.136 | | 4052263.426 | 592891.136 | 4050823.321 | |
| 99 | 592894.598 | | 4052262.851 | 592892.887 | 4050816.748 | |
| 100 | 592895.373 | | 4052265.897 | 592897.864 | 4050809.167 | |
| 101 | 592895.003 | | 4052261.671 | 592895.003 | 4050801.576 | |
| 102 | 592879.925 | | 4052231.765 | 592878.219 | 4050785.675 | |
| 103 | 592878.724 | | 4052226.703 | 592877.020 | 4050780.664 | |
| 104 | 592862.172 | | 4052212.263 | 592862.172 | 4050770.175 | |
| 105 | 592891.539 | | 4052212.198 | 592888.823 | 4050766.110 | |
| 106 | 592894.252 | | 4052212.459 | 592902.837 | 4050766.376 | |
| 107 | 592913.643 | | 4052201.643 | 592913.643 | 4050769.061 | |
| 108 | 592928.323 | | 4052224.358 | 592926.599 | 4050778.270 | |
| 109 | 592941.861 | | 4052232.993 | 592940.132 | 4050786.861 | |
| 110 | 592946.407 | | 4052242.251 | 592946.407 | 4050796.156 | |
| 111 | 592965.994 | | 4052257.301 | 592964.247 | 4050811.391 | |
| 112 | 593001.780 | | 4052266.863 | 593000.027 | 4050820.758 | |
| 113 | 593009.549 | | 4052271.344 | 593007.793 | 4050827.837 | |
| 114 | 593034.414 | | 4052285.867 | 593043.844 | 4050849.751 | |
| 115 | 593041.803 | | 4052307.124 | 593046.035 | 4050861.004 | |
| 116 | 593050.938 | | 4052323.761 | 593048.766 | 4050877.634 | |

Adana Kültür Varlıklarını
Koruma Bölge Kurulunun
27.03.2022 gününde yayımlı
Kararı ile

5
15

SU YOLU KORUNMA ALANI KOORDİNAT ÖZET ÇİZELGESİ

UTM 3 ITRF 96

UTM 6 ED 50

UTM 3 ITRF 96

UTM 6 ED 50

| Nocta No | (UTM)Universal Y | Trans X | ITRF96 (Internations X | (UTM)Universal Y2 | Trans X2 | ED50 (European Datum X2 |
|----------|---------------------|-------------|---------------------------|----------------------|-------------|----------------------------|
| 1 | 590796.274 | 4054585.810 | 4054585.810 | 590795.687 | 4053207.767 | |
| 2 | 590826.779 | 4054644.337 | 4054644.337 | 590831.97 | 4053197.292 | |
| 3 | 590902.927 | 4054621.325 | 4054621.325 | 590901.998 | 4053174.295 | |
| 4 | 590918.524 | 4054617.220 | 4054617.220 | 590917.589 | 4053170.191 | |
| 5 | 590921.918 | 4054611.359 | 4054611.359 | 590921.918 | 4053164.295 | |
| 6 | 590943.681 | 4054579.903 | 4054579.903 | 590942.738 | 4053132.889 | |
| 7 | 590968.456 | 4054568.809 | 4054568.809 | 590967.591 | 4053121.600 | |
| 8 | 590995.008 | 4054564.527 | 4054564.527 | 590991.044 | 4053115.515 | |
| 9 | 591027.274 | 4054562.836 | 4054562.836 | 591026.297 | 4053105.833 | |
| 10 | 591062.409 | 4054539.704 | 4054539.704 | 591061.417 | 4053092.706 | |
| 11 | 591099.335 | 4054526.457 | 4054526.457 | 591099.335 | 4053084.544 | |
| 12 | 591106.687 | 4054520.844 | 4054520.844 | 591105.678 | 4053073.853 | |
| 13 | 591122.537 | 4054512.266 | 4054512.266 | 591121.522 | 4053065.279 | |
| 14 | 591167.538 | 4054468.092 | 4054468.092 | 591156.509 | 4053022.722 | |
| 15 | 591185.967 | 4054446.464 | 4054446.464 | 591185.927 | 4052999.502 | |
| 16 | 591203.775 | 4054424.780 | 4054424.780 | 591202.728 | 4052977.828 | |
| 17 | 591209.263 | 4054412.077 | 4054412.077 | 591208.213 | 4052965.729 | |
| 18 | 591247.680 | 4054381.090 | 4054381.090 | 591246.616 | 4052944.292 | |
| 19 | 591300.521 | 4054292.871 | 4054292.871 | 591299.436 | 4052845.970 | |
| 20 | 591351.371 | 4054224.094 | 4054224.094 | 591350.266 | 4052777.220 | |
| 21 | 591380.888 | 4054184.404 | 4054184.404 | 591379.771 | 4052737.545 | |
| 22 | 591389.168 | 4054173.612 | 4054173.612 | 591388.048 | 4052726.758 | |
| 23 | 591451.071 | 4054073.151 | 4054073.151 | 591449.873 | 4052626.356 | |
| 24 | 591485.425 | 4054029.936 | 4054029.936 | 591484.267 | 4052583.138 | |
| 25 | 591541.190 | 4053942.419 | 4053942.419 | 591540.011 | 4052495.656 | |
| 26 | 591569.291 | 4053909.211 | 4053909.211 | 591568.100 | 4052482.461 | |
| 27 | 591573.453 | 4053901.145 | 4053901.145 | 591578.258 | 4052454.398 | |
| 28 | 591621.921 | 4053864.025 | 4053864.025 | 591620.710 | 4052417.252 | |
| 29 | 591663.891 | 4053824.859 | 4053824.859 | 591662.663 | 4052378.142 | |
| 30 | 591712.277 | 4053791.000 | 4053791.000 | 591711.031 | 4052344.297 | |
| 31 | 591750.653 | 4053771.743 | 4053771.743 | 591749.392 | 4052325.047 | |
| 32 | 591769.113 | 4053762.411 | 4053762.411 | 591767.844 | 4052315.719 | |
| 33 | 591803.915 | 4053733.487 | 4053733.487 | 591802.632 | 4052286.816 | |
| 34 | 591842.644 | 4053668.287 | 4053668.287 | 591841.350 | 4052221.632 | |
| 35 | 591924.444 | 4053535.215 | 4053535.215 | 591923.114 | 4052088.612 | |
| 36 | 591959.549 | 4053454.739 | 4053454.739 | 591958.205 | 4052008.162 | |
| 37 | 591977.944 | 4053421.915 | 4053421.915 | 591976.494 | 4051976.151 | |
| 38 | 592011.808 | 4053382.124 | 4053382.124 | 592010.443 | 4051935.581 | |
| 39 | 592021.145 | 4053367.724 | 4053367.724 | 592019.777 | 4051921.187 | |
| 40 | 592050.950 | 4053298.550 | 4053298.550 | 592058.556 | 4051878.036 | |
| 41 | 592085.220 | 4053299.383 | 4053299.383 | 592083.826 | 4051852.882 | |
| 42 | 592121.952 | 4053237.052 | 4053237.052 | 592120.544 | 4051790.606 | |
| 43 | 592160.696 | 4053194.134 | 4053194.134 | 592159.451 | 4051754.856 | |
| 44 | 592169.957 | 4053201.328 | 4053201.328 | 592159.535 | 4051746.878 | |
| 45 | 592186.187 | 4053193.346 | 4053193.346 | 592167.780 | 4051746.878 | |
| 46 | 592196.337 | 4053187.037 | 4053187.037 | 592164.904 | 4051746.878 | |
| 47 | 592222.280 | 4053111.895 | 4053111.895 | 592220.813 | 4051665.458 | |
| 48 | 592241.916 | 4053076.699 | 4053076.699 | 592240.462 | 4051632.235 | |
| 49 | 592247.854 | 4053072.859 | 4053072.859 | 592246.377 | 4051628.429 | |
| 50 | 592289.682 | 4053052.802 | 4053052.802 | 592288.268 | 4051588.677 | |
| 51 | 592314.604 | 4053006.622 | 4053006.622 | 592313.120 | 4051560.227 | |
| 52 | 592344.112 | 4052996.499 | 4052996.499 | 592342.617 | 4051532.115 | |
| 53 | 592350.341 | 4052992.809 | 4052992.809 | 592345.844 | 4051526.427 | |
| 54 | 592360.967 | 4052997.273 | 4052997.273 | 592359.466 | 4051510.897 | |
| 55 | 592376.788 | 4052992.170 | 4052992.170 | 592374.281 | 4051475.808 | |
| 56 | 592414.295 | 4052863.383 | 4052863.383 | 592412.864 | 4051450.531 | |
| 57 | 592430.265 | 4052834.067 | 4052834.067 | 592428.737 | 4051387.740 | |
| 58 | 592453.195 | 4052793.754 | 4052793.754 | 592451.658 | 4051347.443 | |

| Nocta No | (UTM)Universal Y | Trans X | ITRF96 (Internations X | (UTM)Universal Y2 | Trans X2 | ED50 (European Datum X2 |
|----------|---------------------|-------------|---------------------------|----------------------|-------------|----------------------------|
| 59 | 592469.982 | 4052779.297 | 4052779.297 | 592468.438 | 4051332.991 | |
| 60 | 592510.237 | 4052771.804 | 4052771.804 | 592507.811 | 4051295.513 | |
| 61 | 592554.491 | 4052715.358 | 4052715.358 | 592552.913 | 4051269.077 | |
| 62 | 592588.409 | 4052693.756 | 4052693.756 | 592586.819 | 4051247.483 | |
| 63 | 592622.255 | 4052681.116 | 4052681.116 | 592619.821 | 4051240.356 | |
| 64 | 592668.270 | 4052674.123 | 4052674.123 | 592666.674 | 4051227.859 | |
| 65 | 592623.599 | 4052653.986 | 4052653.986 | 592621.594 | 4051207.730 | |
| 66 | 592668.410 | 4052649.788 | 4052649.788 | 592666.796 | 4051173.548 | |
| 67 | 592674.752 | 4052642.543 | 4052642.543 | 592673.727 | 4051158.523 | |
| 68 | 592689.544 | 4052656.900 | 4052656.900 | 592687.913 | 4051120.677 | |
| 69 | 592703.279 | 4052554.343 | 4052554.343 | 592701.643 | 4051109.726 | |
| 70 | 592717.915 | 4052543.892 | 4052543.892 | 592715.873 | 4051097.339 | |
| 71 | 592726.681 | 4052537.599 | 4052537.599 | 592725.636 | 4051091.298 | |
| 72 | 592734.557 | 4052532.540 | 4052532.540 | 592732.909 | 4051086.331 | |
| 73 | 592743.274 | 4052528.265 | 4052528.265 | 592741.623 | 4051080.858 | |
| 74 | 592751.717 | 4052520.908 | 4052520.908 | 592750.062 | 4051074.704 | |
| 75 | 592763.737 | 4052502.250 | 4052502.250 | 592762.078 | 4051066.053 | |
| 76 | 592772.760 | 4052494.171 | 4052494.171 | 592771.106 | 4051027.985 | |
| 77 | 592775.197 | 4052466.336 | 4052466.336 | 592773.533 | 4051020.153 | |
| 78 | 592780.793 | 4052439.258 | 4052439.258 | 592779.126 | 4050993.086 | |
| 79 | 592799.424 | 4052415.459 | 4052415.459 | 592797.751 | 4050969.296 | |
| 80 | 592805.563 | 4052407.290 | 4052407.290 | 592803.887 | 4050961.130 | |
| 81 | 592841.886 | 4052381.805 | 4052381.805 | 592840.196 | 4050935.855 | |
| 82 | 592843.957 | 4052377.007 | 4052377.007 | 592842.290 | 4050930.859 | |
| 83 | 592842.895 | 4052371.937 | 4052371.937 | 592841.205 | 4050925.791 | |
| 84 | 592836.342 | 4052363.700 | 4052363.700 | 592834.654 | 4050907.561 | |
| 85 | 592847.664 | 4052333.522 | 4052333.522 | 592845.972 | 4050887.292 | |
| 86 | 592870.298 | 4052337.171 | 4052337.171 | 592868.507 | 4050891.039 | |
| 87 | 592880.417 | 4052338.633 | 4052338.633 | 592878.712 | 4050892.500 | |
| 88 | 592882.603 | 4052339.064 | 4052339.064 | 592880.896 | 4050892.501 | |
| 89 | 592884.792 | 4052331.441 | 4052331.441 | 592884.894 | 4050885.311 | |
| 90 | 592889.959 | 4052324.910 | 4052324.910 | 592888.250 | 4050878.783 | |
| 91 | 592893.839 | 4052317.896 | 4052317.896 | 592892.128 | 4050871.772 | |
| 92 | 592924.600 | 4052294.000 | 4052294.000 | 592915.652 | 4050869.529 | |
| 93 | 592894.982 | 4052309.647 | 4052309.647 | 592893.271 | 4050863.526 | |
| 94 | 592894.840 | 4052309.990 | 4052309.990 | 592893.129 | 4050862.560 | |
| 95 | 592881.515 | 4052288.773 | 4052288.773 | 592887.909 | 4050822.580 | |
| 96 | 592886.000 | 4052274.658 | 4052274.658 | 592885.093 | 4050828.580 | |
| 97 | 592888.055 | 4052270.977 | 4052270.977 | 592886.347 | 4050824.971 | |
| 98 | 592885.036 | 4052268.758 | 4052268.758 | 592884.758 | 4050822.583 | |
| 99 | 592880.908 | 4052261.246 | 4052261.246 | 592879.203 | 4050818.144 | |
| 100 | 592875.753 | 4052251.577 | 4052251.577 | 592874.049 | 4050808.478 | |
| 101 | 592876.451 | 4052244.454 | 4052244.454 | 592868.584 | 4050798.363 | |
| 102 | 592868.317 | 4052226.335 | 4052226.335 | 592866.617 | 4050786.146 | |
| 103 | 592874.352 | 4052208.880 | 4052208.880 | 592872.649 | 4050762.798 | |
| 104 | 592869.517 | 4052202.195 | 4052202.195 | 592867.800 | 4050756.676 | |
| 105 | 592906.096 | 4052202.488 | 4052202.488 | 592904.380 | 4050756.400 | |
| 106 | 592917.795 | 4052205.944 | 4052205.944 | 592916.075 | 4050759.863 | |
| 107 | 592933.681 | 4052215.902 | 4052215.902 | 592931.935 | 4050769.817 | |
| 108 | 592946.795 | 4052224.240 | 4052224.240 | 592945.063 | 4050778.152 | |
| 109 | 592965.200 | 4052233.468 | 4052233.468 | 592963.461 | 4050787.376 | |
| 110 | 592991.113 | 4052248.801 | 4052248.801 | 592969.364 | 4050802.703 | |
| 111 | 593007.779 | 4052267.898 | 4052267.898 | 593001.824 | 4050809.299 | |
| 112 | 593016.224 | 4052266.801 | 4052266.801 | 593014.466 | 4050820.394 | |
| 113 | 593042.036 | 4052289.255 | 4052289.255 | 593040.267 | 4050843.142 | |
| 114 | 593050.431 | 4052304.859 | 4052304.859 | 593052.044 | 4050855.426 | |
| 115 | 593058.685 | 4052317.766 | 4052317.766 | 593056.914 | 4050867.441 | |
| 116 | 593074.651 | 4052333.733 | 4052333.733 | 593072.869 | 4050887.602 | |

Adana Kültür Varlıklarını

Koruma Bölge Kurulunun

27.05.2016 gününde

Karar Yaptı

SÖMEK ANTİK SU YOLU TESCİL VE KORUNMA ALANINA GİREN PARSELLER LİSTESİ

SEYDİLİ MAHALLESİ

- 364 PARSEL
- 362 PARSEL
- 365 PARSEL
- 101 ADA 6 PARSEL
- 361 PARSEL
- 101 ADA 2 PARSEL
- 360 PARSEL
- 357 PARSEL
- 356 PARSEL
- 354 PARSEL
- 358 PARSEL

ŞAHMURLU MAHALLESİ

- 153 ADA 18 PARSEL
- 153 ADA 21 PARSEL
- 153 ADA 13 PARSEL
- 143 ADA 136 PARSEL
- 143 ADA 2 PARSEL
- 143 ADA 1 PARSEL
- 101 ADA 1 PARSEL
- 152 ADA 1 PARSEL
- 152 ADA 2 PARSEL
- 153 ADA 13 PARSEL
- 155 ADA 1 PARSEL
- 153 ADA 19 PARSEL

CAMBAZLI MAHALLESİ

- 104 ADA 3 PARSEL
- 104 ADA 4 PARSEL
- 104 ADA 5 PARSEL
- 104 ADA 6 PARSEL
- 104 ADA 8 PARSEL
- 104 ADA 2 PARSEL
- 104 ADA 7 PARSEL
- 103 ADA 1 PARSEL
- 103 ADA 23 PARSEL
- 103 ADA 11 PARSEL
- 103 ADA 6 PARSEL
- 103 ADA 8 PARSEL
- 103 ADA 26 PARSEL
- 103 ADA 7 PARSEL
- 103 ADA 9 PARSEL
- 103 ADA 10 PARSEL

| Adana Kültür Varlıklarını Koruma Bölge Kurulunun Kararı | |
|--|--|
| Başkan | |
| Başkan Yardımcısı | |
| Üye | |
| Üye | |
| Üye | |
| Üye | |
| Üye | |
| Üye | |

Adana Kültür Varlıklarını
Koruma Bölge Kurulunun
27.03.2016
Karar Ekidir

m 13









102 ADA 271 PARSEL
102 ADA 291 PARSEL
104 ADA 1 PARSEL
102 ADA 292 PARSEL
102 ADA 300 PARSEL
102 ADA 299 PARSEL
102 ADA 305 PARSEL
102 ADA 304 PARSEL
102 ADA 303 PARSEL
102 ADA 302 PARSEL
102 ADA 301 PARSEL

YEĞENLİ MAHALLESİ

307 PARSEL
101 ADA 1 PARSEL
747 PARSEL
47 PARSEL
748 PARSEL
749 PARSEL

SÖMEK MAHALLESİ

101 ADA 176 PARSEL
101 ADA 853 PARSEL
101 ADA 852 PARSEL
101 ADA 179 PARSEL
102 ADA 9 PARSEL
102 ADA 8 PARSEL
102 ADA 7 PARSEL
102 ADA 6 PARSEL
102 ADA 5 PARSEL
102 ADA 4 PARSEL
102 ADA 3 PARSEL
102 ADA 2 PARSEL
101 ADA 165 PARSEL
101 ADA 857 PARSEL
101 ADA 174 PARSEL
101 ADA 314 PARSEL
101 ADA 189 PARSEL
101 ADA 190 PARSEL
101 ADA 192 PARSEL
101 ADA 184 PARSEL
101 ADA 183 PARSEL
101 ADA 181 PARSEL
101 ADA 166 PARSEL
101 ADA 167 PARSEL
101 ADA 168 PARSEL

| Adana Kültür Varlıklarını Koruma Bölge Kurulu Onayı | |
|--|--|
| Başkan |  |
| Başkan Yard. |  |
| Üye |  |
| Üye |  |
| Üye |  |
| Üye |  |
| Üye |  |
| Üye |  |

Adana Kültür Varlıklarını
Koruma Bölge Kurulunun
27.03.2024, gün, 1528. sayılı
Karar Ekidir



101 ADA 169 PARSEL
 101 ADA 170 PARSEL
 101 ADA 171 PARSEL
 101 ADA 173 PARSEL
 101 ADA 859 PARSEL
 101 ADA 276 PARSEL
 101 ADA 860 PARSEL
 101 ADA 275 PARSEL
 101 ADA 274 PARSEL
 119 ADA 1708 PARSEL
 124 ADA 49 PARSEL
 124 ADA 48 PARSEL
 124 ADA 47 PARSEL
 124 ADA 46 PARSEL
 124 ADA 45 PARSEL
 124 ADA 30 PARSEL
 124 ADA 89 PARSEL
 124 ADA 27 PARSEL
 124 ADA 26 PARSEL
 124 ADA 25 PARSEL
 124 ADA 22 PARSEL
 124 ADA 21 PARSEL
 124 ADA 20 PARSEL
 124 ADA 91 PARSEL
 108 ADA 56 PARSEL
 108 ADA 57 PARSEL
 108 ADA 58 PARSEL
 108 ADA 59 PARSEL
 108 ADA 55 PARSEL
 108 ADA 54 PARSEL
 108 ADA 52 PARSEL
 108 ADA 50 PARSEL
 108 ADA 39 PARSEL
 108 ADA 38 PARSEL
 101 ADA 452 PARSEL
 101 ADA 456 PARSEL
 101 ADA 439 PARSEL
 101 ADA 461 PARSEL
 101 ADA 659 PARSEL
 101 ADA 658 PARSEL
 101 ADA 657 PARSEL
 101 ADA 656 PARSEL
 101 ADA 655 PARSEL
 101 ADA 654 PARSEL
 101 ADA 653 PARSEL
 101 ADA 652 PARSEL
 131 ADA 10 PARSEL
 131 ADA 13 PARSEL
 131 ADA 14 PARSEL
 131 ADA 15 PARSEL
 131 ADA 16 PARSEL
 131 ADA 17 PARSEL
 131 ADA 21 PARSEL

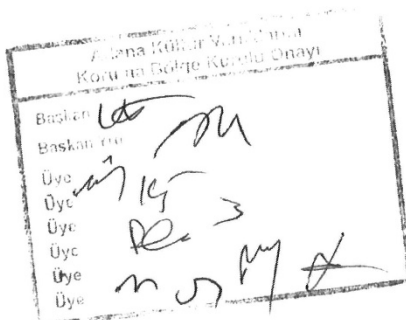

Adana Kültür Varlıklarını
 Koruma Bölge Kurulunun
 27.05.2021 tarihli 19526 sayılı
 Kararı ile

Handwritten initials or signature.

SÖMEK ANTİK SU YOLU TESCİL VE KORUNMA ALANI HARİTASI

İL: MERSİN 939.8

İLÇE: SİLİFKE

1/15000

MAHALLE: SEYDİLİ, ŞAHMURLU,

CAMBAZLI, YEĞENLİ, SÖMEK

ADA/PARSEL LİSTESİ EKTEDİR.

ADANA KÜLTÜR VARLIKLARINI KORUMA BÖLGE

KURULUNUN 15.05.2011 GÜN VE 1156

SAYILI KARAR EKİDİR.

ADANA KÜLTÜR VARLIKLARINI KORUMA
BÖLGE KURULU ONAYI

BAŞKAN

BAŞKAN YRD.

ÜYE

ÜYE

ÜYE

ÜYE

ÜYE

ÜYE

ÜYE

LEJANT

SU YOLU GÜZERGAHI
KORUNMA ALANI SINIRI

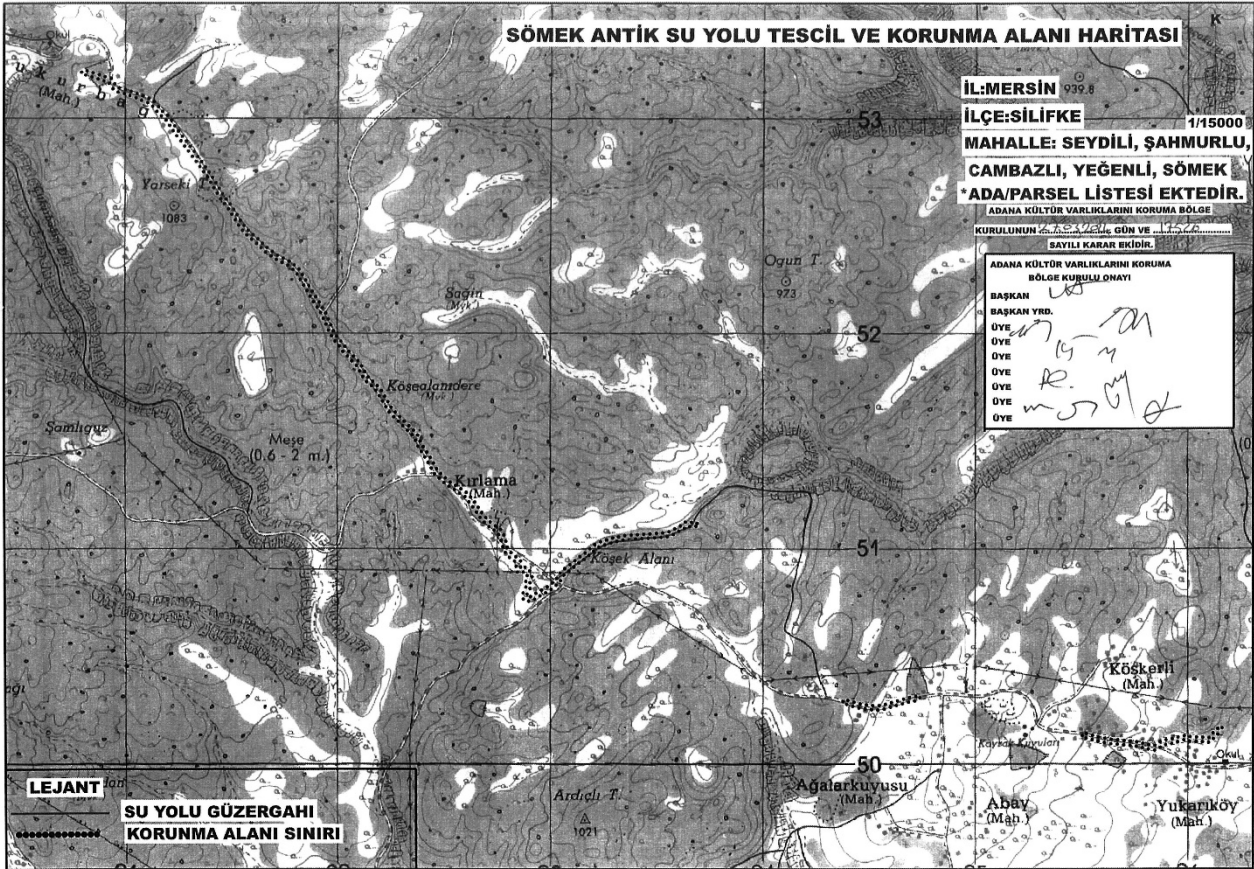

SÖMEK ANTİK SU YOLU TESCİL VE KORUNMA ALANI HARİTASI



İL: MERSİN
İLÇE: SİLİFKE
MAHALLE: SEYDİLİ, ŞAHMURLU,
CAMBAZLI, YEĞENLİ, SÖMEK
*ADA/PARSEL LİSTESİ EKTEDİR.

1/15000

ADANA KÜLTÜR VARLIKLARINI KORUMA BÖLGE
KURULUŞUNUN 27.07.2014 GÜN VE 13526
SAYILI KARAR EKİDİR.

ADANA KÜLTÜR VARLIKLARINI KORUMA
BÖLGE KURULU ÖNERİ

BAŞKAN
BAŞKAN YRD.

ÖYE
ÖYE
ÖYE
ÖYE
ÖYE

LEJANT

— SU YOLU GÜZERGAHI
●●●●●●●●●● KORUNMA ALANI SINIRI
— KADASTRAL PARSEL SINIRI